

Toucan Eco Active Plus install guide

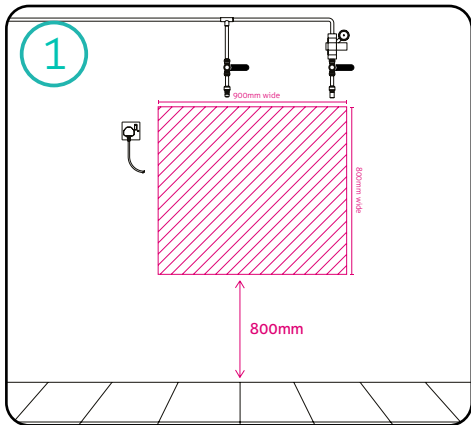

Choose a wall space of 900mm wide by 800mm high at 800mm above floor level, and close to a water and electrical supply (water pressure up to 4 bar), and install 15mm pipework, 2 lever valves and a pressure reducing valve.

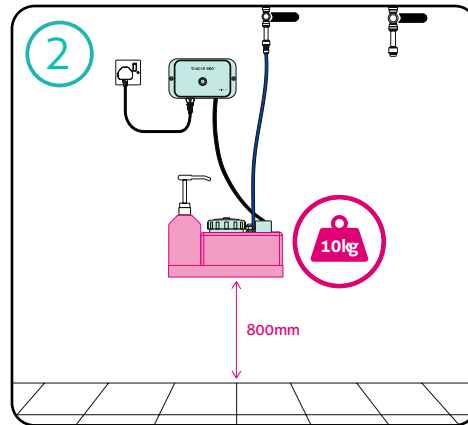

Fix the shelf to the wall 800mm above the floor, making sure it can take 10kg, and place the 5L tank and brine container onto the shelf and fix the control box to the wall. Connect the blue tube from the tank to the 15mm pipework.

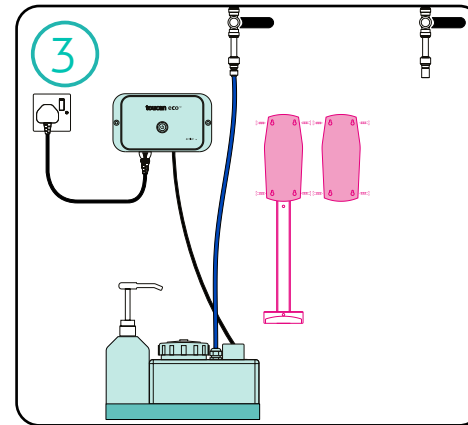

Remove the dispenser mechanisms and fix the enclosure backs and spray bottle stand to the wall. Please refer to the Brightwell Ecomix instructions provided for further details.

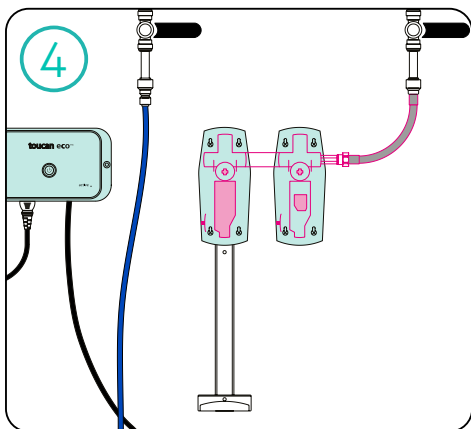

Replace the dispenser mechanism. Attach the silver pipe from the mains to the dispenser.

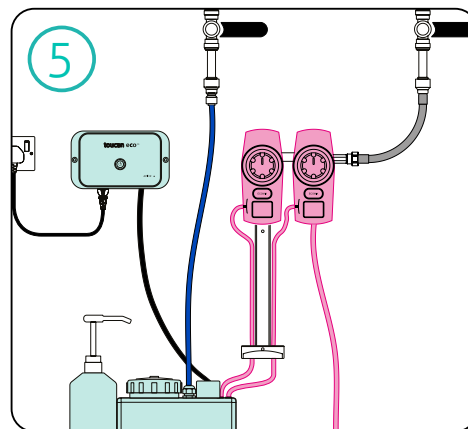

Connect the clear tubes from the 5L tank to each dispenser. Replace the dispenser enclosure fronts.

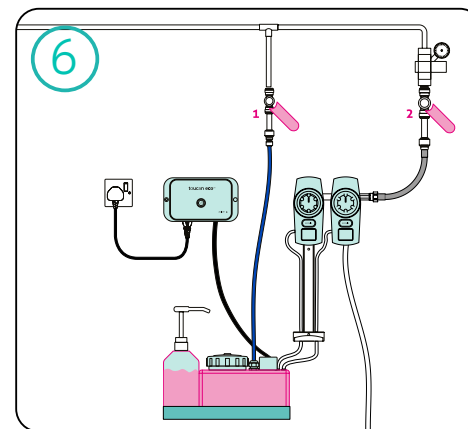

Turn lever 2 to the on position. Add granulated salt to the brine dispenser to a depth of 5cm and top up with water. Fill the 5L tank with water using lever 1. This is now ready to operate.

Components



5L holding tank and control box.



2.5L brine container and dispenser.



Control box power lead.

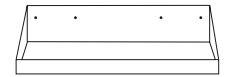

Stainless steel shelf.



2x 15mm to 10mm reducer.



10mm blue feeder pipe.

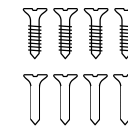

4x shelf screws and wall plugs.

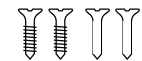

2x control box screw and wall plugs.

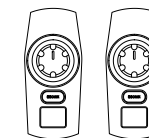

2x dispenser, bottle holder, tube and fittings.

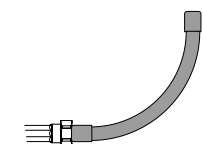

Silver pipe